

INSERT

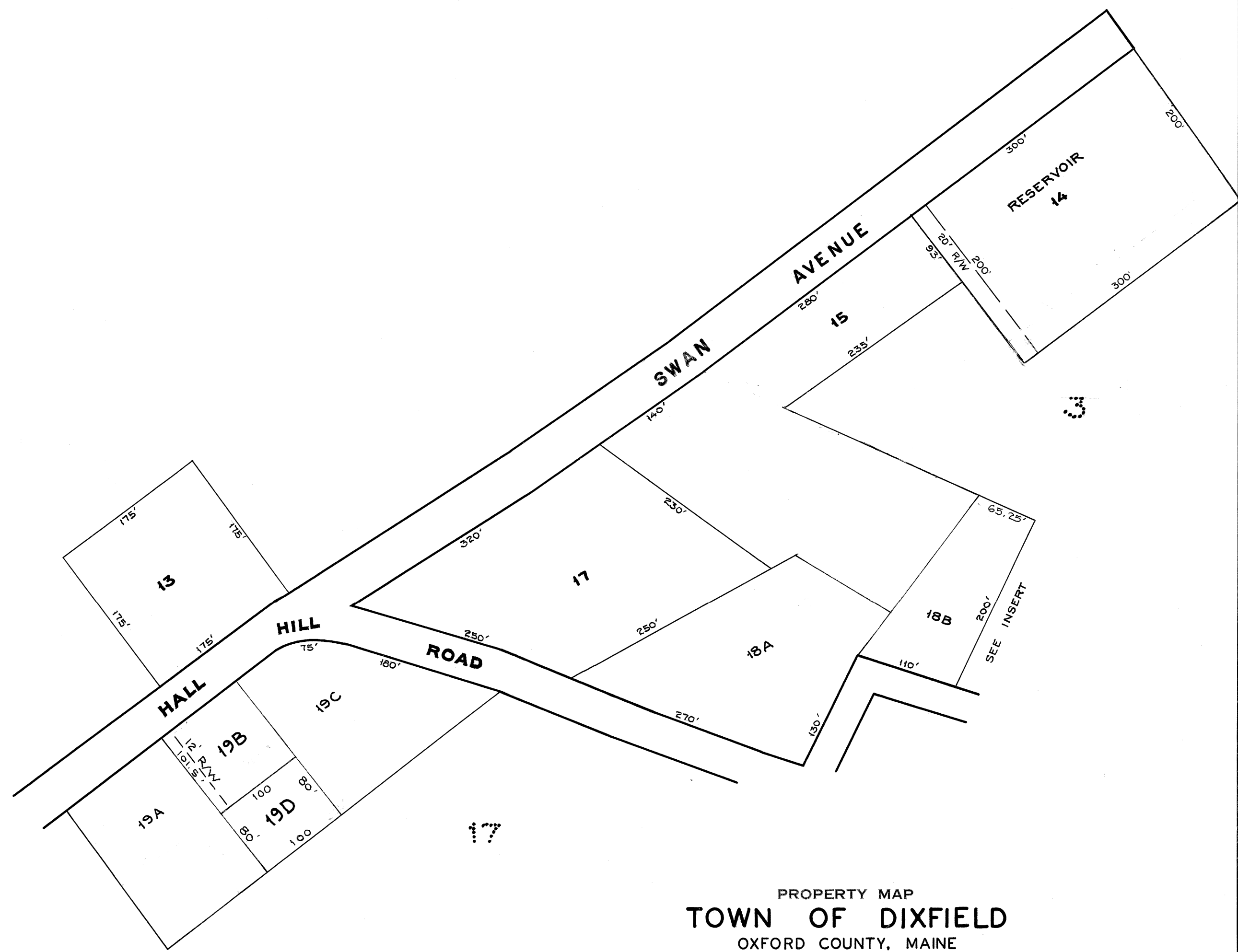

LEGEND
 PARCEL NUMBERS 1
 ADJACENT MAPS 2
 MATCH LINE 3
 For Assessment Purposes
 Not To Be Used For Conveyances

PROPERTY MAP
TOWN OF DIXFIELD
 OXFORD COUNTY, MAINE
 JAMES W. SEWALL COMPANY OLD TOWN, MAINE
 SCALE 1 INCH = 100 ± FEET APRIL 1, 1957